

Shrubs

- Artp ~ Artemisia Fovis Castle ~ 15-30 cms ~ 3L ~ 5/m<sup>2</sup> ~ 5rr
- Angel ~ Angelica archangelica ~ " ~ 5L ~ 1/m<sup>2</sup> ~ 1rr
- Aucjr ~ Aucuba japonica Kozannie ~ 30-40 cms ~ 5L ~ 3/m<sup>2</sup> ~ 6rr
- BerbH ~ Berberis Helmond Pillar ~ 30-40 cms ~ 5L ~ 3/m<sup>2</sup> ~ 5rr

- Berbr ~ Berberis 'Kobeglow' ~ 30-40 cms ~ 5L ~ 3/m<sup>2</sup> ~ 3rr
- Bergo ~ Bergeia 'Overture' ~ 15-30 cms ~ 3L ~ 5/m<sup>2</sup> ~ 25rr
- Centr ~ Centranthus rubra ~ herbaceous ~ 3L ~ 5/m<sup>2</sup> ~ 5rr
- Digitalis ~ Digitalis purpurea ~ " ~ 3L ~ 5/m<sup>2</sup> ~ 5rr
- Dryoa ~ Dryopteris affinis ~ 30-40 cms ~ 5L ~ 4/m<sup>2</sup> ~ 8rr
- Escr ~ Escallonia rubra 'Crimson Spire' ~ 60-90 cms ~ 5L ~ 3/m<sup>2</sup> ~ 3rr
- Euofs ~ Euonymus fortunei 'Sunshine' ~ 30-40 cms ~ 5L ~ 5/m<sup>2</sup> ~ 5rr
- Fatohed ~ Fatohedera x lizei ~ 15-30 cms ~ 3L ~ 5/m<sup>2</sup> ~ 15rr
- Fatsj ~ Fatsia japonica ~ 45-60 cms ~ 10L ~ 1/m<sup>2</sup> ~ 1rr
- Germ ~ Geranium macrorrhizum 'Zakor' ~ 15-30 cms ~ 3L ~ 6/m<sup>2</sup> ~ 12rr
- Hak.m ~ Hakonochloa macro aureola ~ 15-30 cms ~ 3L ~ 5/m<sup>2</sup> ~ 1rr
- Mahws ~ Mahonia Winter Sun ~ 45-60 cms ~ 5L ~ 3/m<sup>2</sup> ~ 3rr
- Melia ~ Melianthus major ~ 45-60 cms ~ 10L ~ 1/m<sup>2</sup> ~ 1rr
- Misc ~ Miscanthus Kleine Fontaine ~ 60-90 cms ~ 5L ~ 3/m<sup>2</sup> ~ 3rr
- Sach ~ Sachysandra terminalis ~ 15-30 cms ~ 3L ~ 5/m<sup>2</sup> ~ 15rr
- Pitt ~ Pittosporum Tom Thumb ~ 30-40 cms ~ 5L ~ 3/m<sup>2</sup> ~ 3rr
- Polyss ~ Polistichum polybletharum ~ 30-40 cms ~ 5L ~ 3/m<sup>2</sup> ~ 5rr
- Phiom ~ Phlomis Russeliana ~ 30-40 cms ~ 3L ~ 5/m<sup>2</sup> ~ 5rr
- Rosr ~ Rosa rugosa rubra ~ 30-40 cms ~ 5L ~ 3/m<sup>2</sup> ~ 6rr
- Sedum ~ Sedum Herbstfreude ~ 30-40 cms ~ 5L ~ 3/m<sup>2</sup> ~ 6rr

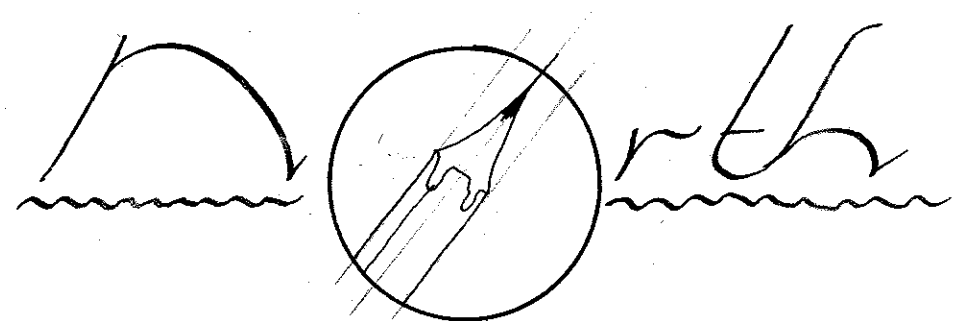
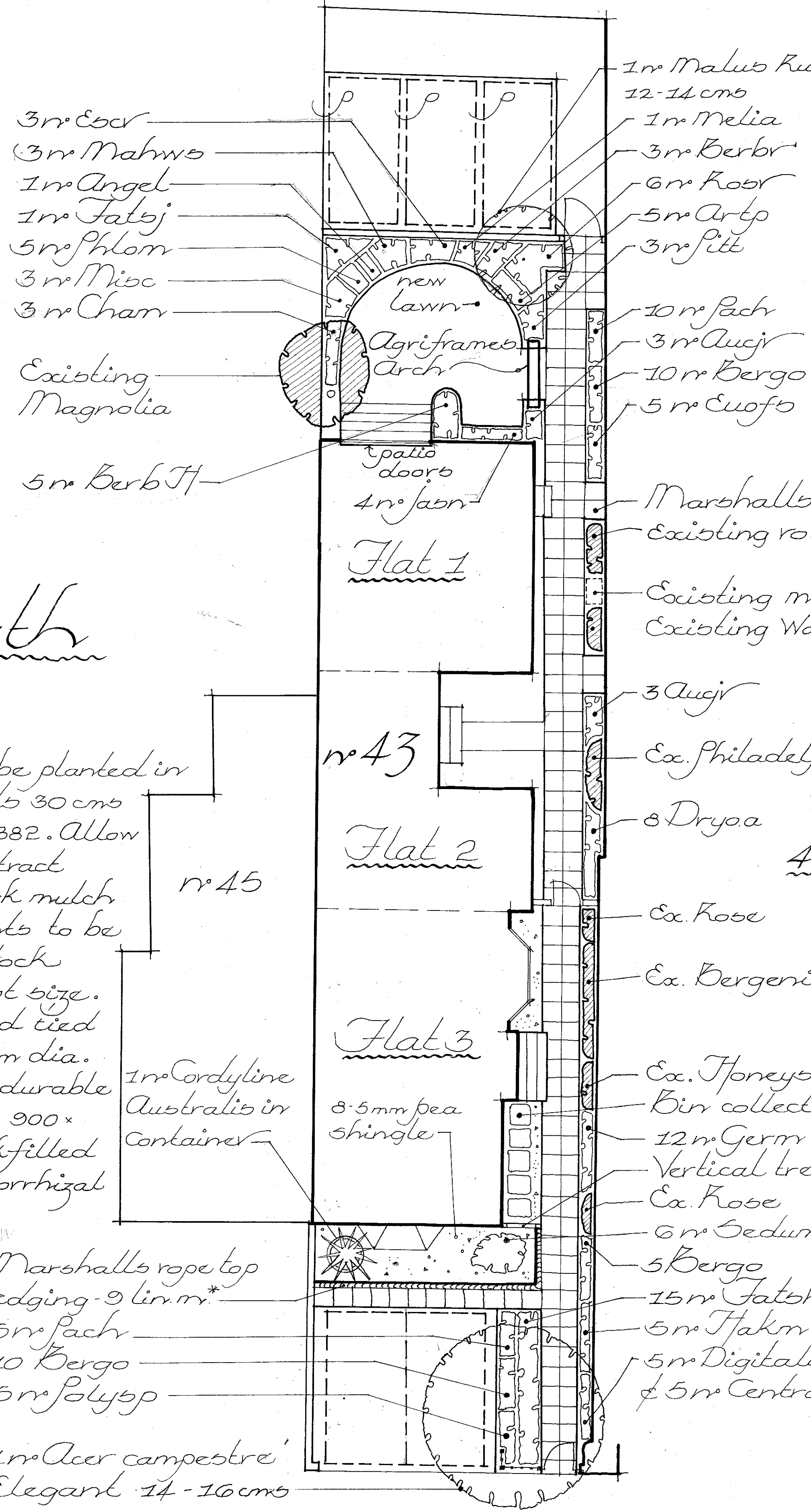

Shrubs to B53936 to be planted in debris & weed free beds 30 cms deep ~ Topsoil to B53882. Allow for 75mm depth of Contract Ornamental grade bark mulch to planting beds. Plants to be good quality bushy stock commensurate with pot size. Trees to be staked and tied at low level using 75mm dia. peeled larch stakes & durable rubber ties. Tree pits 900x900x750 mm deep. Backfilled in layers containing mycorrhizal fungal spores.

43, Auckland Road,  
Doncaster  
Landscaping

1:100 & 1:5  
June 2019

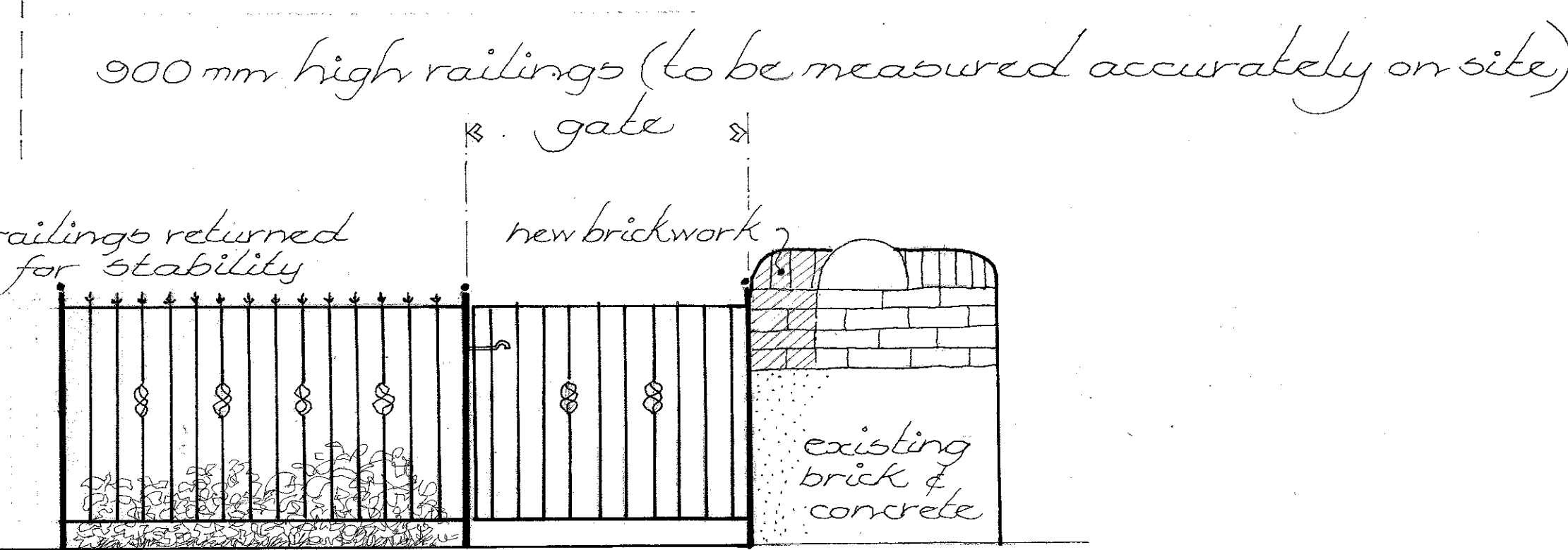
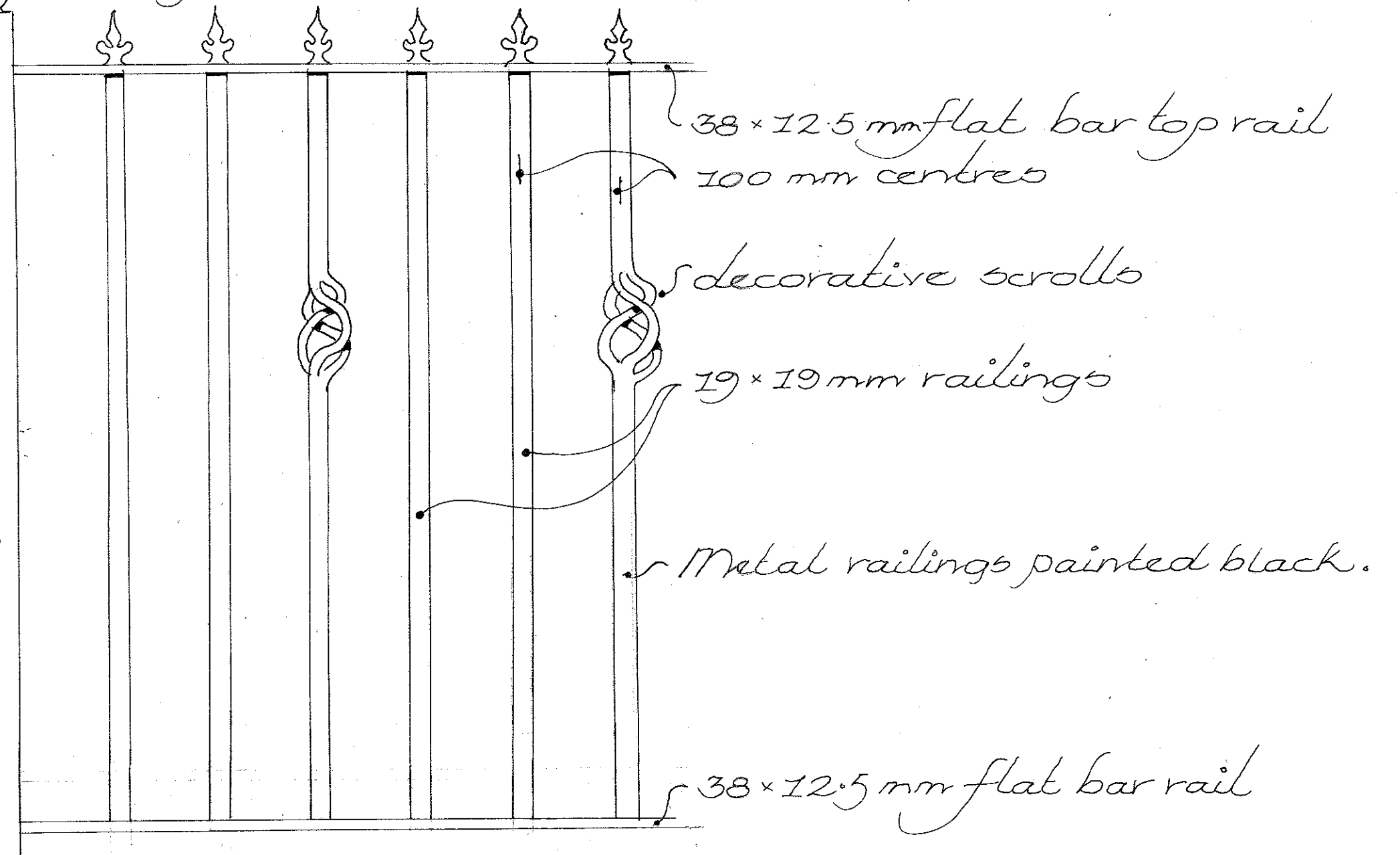

Elevation

\* Re-claimed salt glazed edging preferred if available.

Auckland Road